

PCB Connector — TLP series ( Female Connector )— TLPSW-501

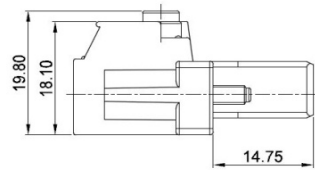
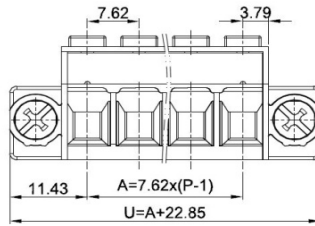
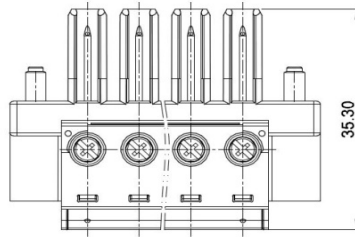

■ 图示(Pic. shown) : TLPSW-501-02P-G12C

General:	PCB Connector Rated : 1000V,41A , 6.0mm <sup>2</sup>
	Single row , 7.62mm pitch , 02-14 Pole
	Wiring orientation: 180°(wire to plug-in)
	Screw clamp unit: M3, 0.8N.m Max

认证 ( Approval ) :



■ 技术参数 Technical Data

UL应用组别(UL Application group)	UL standard			IEC standard		
	UL Application group			IEC过电压别/污染等级(IEC overvoltage category /pollution degree)		
IEC过电压别/污染等级(IEC overvoltage category /pollution degree)	B	C	D	III / 3	III / 2	II / 2
额定电压(Rated voltage)	600V	600V	600V	1000V	1000V	1000V
额定电流(Rated current)	41A	41A	5A	41A	41A	41A
额定连接容量(Rated connection capacity)	24-8AWG Sol&Str			0.2~6.0mm <sup>2</sup>		
绝缘材料(Insulation Material)				PA66 UL94 V-0		
电流承载部件材料和镀层( Material & Plating of Current carrier )				Copper alloy , Tin plated		
接线弹片材料(Material of Clamp spring )				Stainless Steel		
绝缘电阻(Insulation Resistance)				500MΩ or more at DC500V		
耐电压(1分钟)(Withstanding Voltage/1Min)				3300 V		
额定冲击电压(Rated surge voltage)				8000 V		
接线螺丝(Wire clamp unit Screw) , 最大扭矩( torque Max. )				M3 , 0.5 N.m(0.8 N.m Max)		
固定螺丝(Mounting Screw) , 扭矩(torque)				M3 , 0.3-0.4 N.M		
剥线长度(Wire stripping length)				10 mm		
使用温度(Operating temperature)				-40°C up to +115°C		
焊接方式(Soldering recommend)				--		

■ 订购方式(How to order)

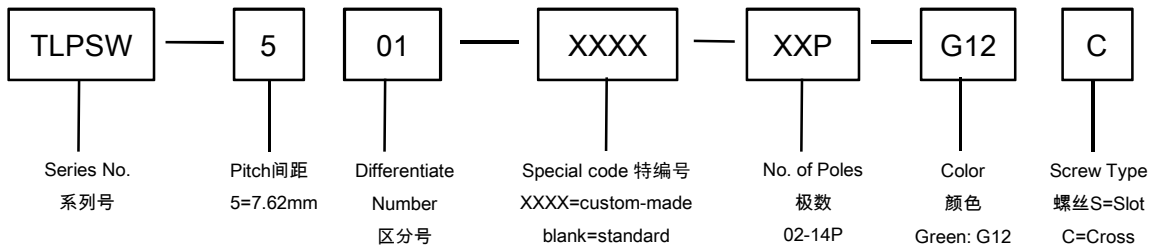

■ 编码片 Codina key



P/N:  
TLPCK-004-S

■ 针座 ( Pin header ) — single row



P/N : TLPHW-501V  
Orientation :  
90° ( plug-in to board )  
Rated:630V,41A  
With threaded flange



P/N : TLPHW-501R  
Orientation :  
180° ( plug-in to board )  
Rated:630V,41A  
With threaded flange

■ 针座 ( Pin header ) — single row



P/N : TLPHW-501RL  
Orientation :  
180° ( plug-in to board )  
Rated:630V,41A  
With threaded flange