

Fuse Terminal Block — TLF series — TLF-100E

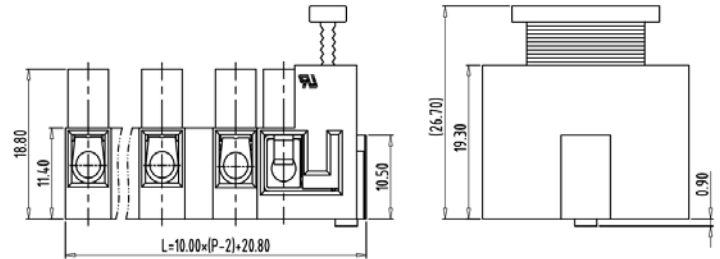
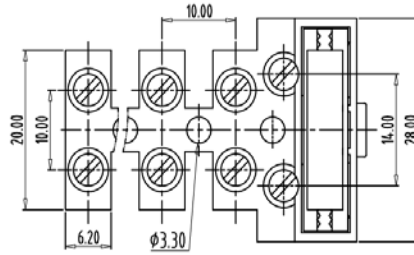

图示(Pic. shown) : TLF-100E-05P-M19S

General:

- Fuse Terminal Block Rated : 450V,24A , 2.5mm²
- Single row , 10.00mm pitch , 02-06 Pole
- Wire-to-Wire Connection
- Screw clamp unit: M3, 0.5Nm Max

认证 (Approval) :

技术参数 Technical Data	UL standard	IEC standard
◆ FUSE BLOCK		
RATING	300V, 13A, 20-14 AWG Sol&Str	250V, 6.3A, 0.5-2.5mm ²
◆ TERMINAL BLOCK		
UL应用组别(UL Application group)	UL Application group	
IEC过电压别/污染等级(IEC overvoltage category /pollution degree)	B	C
额定电压(Rated voltage)	300V	300V
额定电流(Rated current)	30A	10A
额定连接容量(Rated connection capacity)	18-10AWG Sol&Str	
绝缘材料(Insulation Material)	PA66 UL94 V-0	
电流承载部件材料和镀层(Material & Plating of Current carrier)	Copper alloy , Ni plated	
绝缘电阻(Insulation Resistance)	500MΩ or more at DC500V	
耐电压(1分钟)(Withstanding Voltage/1Min)	Terminal Block: 2500V / Fuse Block: 2000V	
额定冲击电压(Rated surge voltage)	--	
接线螺丝(Wire clamp unit Screw) , 最大扭矩(torque Max.)	M3 , 0.5Nm Max	
接地螺丝(Grounding Screw) , 扭矩(torque)	--	
剥线长度(Wire stripping length)	Terminal Block: 7.0mm / Fuse Block: 7.0mm	
使用温度(Operating temperature)	Terminal Block:-30°C up to +105°C / Fuse Block: -30°C up to +40°C	

订购方式(How to order)

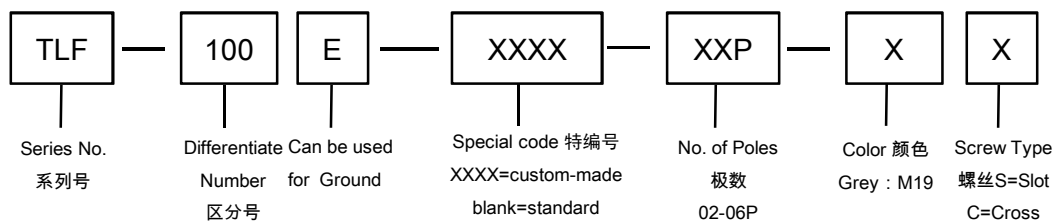

Web:www.china-tianli.com TEL:+86-574-6347-9600,6389-6436 Mail : sale@china-tianli.cn
 地址:中国浙江省宁波杭州湾新区庵东工业园区纬三路138号
 ADD : 138 , Weisan Rd.,Andong Development Zone, Hangzhou Bay Area, Ningbo, Zhejiang, China